

Dedicated rubber bushing (Option)

Model/Specifications

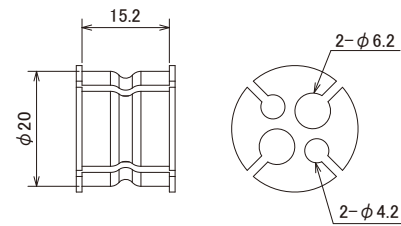

Dimensional drawing



Material: Silicone rubber

Model	Applicable cable dia. (mm)	No. of holes	CC holder model	Color	Weight	Q'ty per pack
GCH-TM	φ 3 to 4 (2 holes) φ 5 to 6 (2 holes)	4	CH-TM1 CH-TM2	Black	5g	5 pcs.

CC Holder Lineup

For securing connectors. Prevents wire breakage and contact failure

RoHS2

For holding connector joints at assembly machines, conveyors, inspection devices or other machines



OL-G4-70 OL-G4-80 OL-G4-90 OL-G4A-80 OL-G4A-90

Center hole type

Spacers for routing cables or tubes out of touch with machine surfaces

RoHS2

Ideal where frequent cleaning and rinsing is required such as cutting machines, or where direct cable/tube attachment is not allowed



OL-F4-30

OL-F4-50

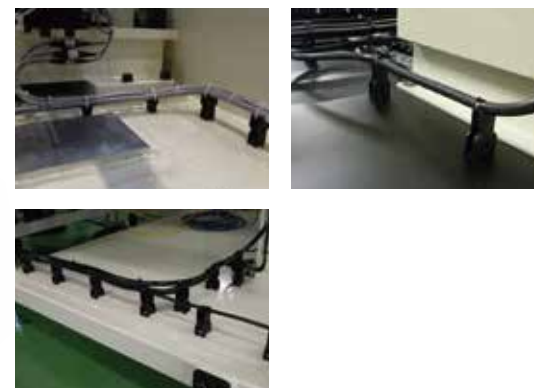

OHM ELECTRIC CO., LTD.

7000-21, Nakagawa, Hosoe, Kita-ku, Hamamatsu, Shizuoka 431-1304, Japan

TEL +81-53-522-5562 FAX +81-53-523-2362 e-mail : info@ohm.co.jp

URL : <http://www.ohm.jp/>

The contents of this catalog are subject to change for product improvement.
Colors of products may slightly differ from actual due to printing.

OHM News vol.185



Cable holder for robots
CC Holder

CH-TM1

CH-TM2

CH-TM3

Multifunctional

Lightens dynamic load on cables or air hoses in robot motion

RoHS2

NEW CC Holder



OHM ELECTRIC CO., LTD.

Cable holder for robots

CC Holder

1 Variable holding diameter to fit the object



3 Projections inside holder secure the tube



2 Use a screwdriver to release the holder

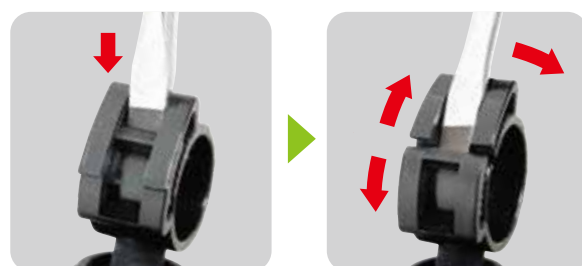

4 Holder moves flexibly



F Holder state changes by rotating dome nut

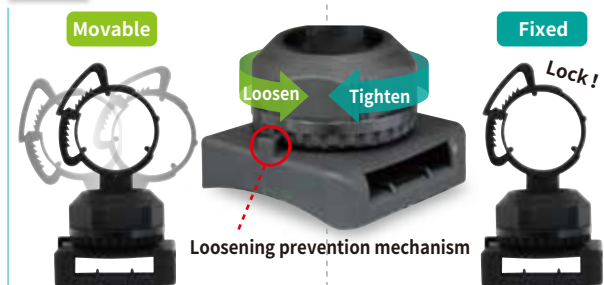

Optional rubber bushing for cables and tubes



7 Positional shift preventing anti-slip packing



Available from two different heights



Positional shift prevention rib that allows banding in multiple ways



10 Plate type enables mounting of junction boxes or other parts!



■ Model/Specifications

Model	Diameter of gripped part	Installation	Holder/Stand design	Working temp.	Color	Weight	Quantity per pack
CH-TM1	ϕ 80	Fixed with banding bands	ϕ 20 ring-shaped	-25 to +80°C	Black	15g	5 pcs.
CH-TM2						16g	
CH-TM3			Flat plate with a pilot hole for M4 tapping			14g	

■ Material

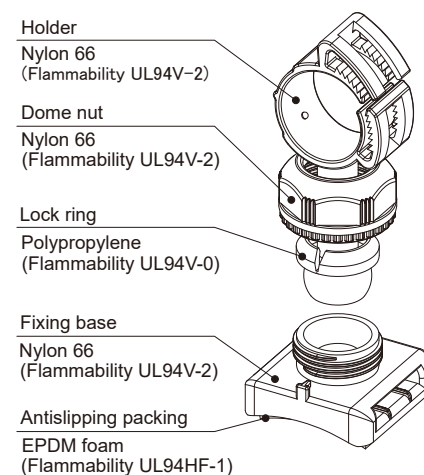

■ Dimensional drawing

